

Double extrusion nuts

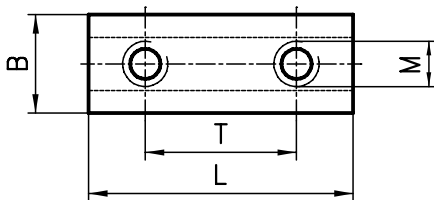

Measurement data

Double extrusion nuts

Extrusion base	B	H	L	T	M
50 (ball)	18	12.2	80	50	M8
40 (ball)	17	8	60	40	M8
50/45	14	7.8	48	33	M6
40 (ball)	13.6	5.9	38	28.7	M6

Swivel in double extrusion nuts

Extrusion base	B	H	L	T	M
50/45	14	7.8	40	30	M6
40 (ball)	13.6	5.9	40	30	M6
30	11	4.1	40	30	M6
30	11	4.1	30	18	M4

Application

Double extrusion nuts should be used with PVS® threaded connectors where extremely high strength joints are required. Swivel in double extrusion nuts are used for the assembly of hinges (page 195) and quick-release fasteners (page 204).



Order data

Order number

Double extrusion nuts		Extrusion base		
Thread M		50	40	30
M8		A32-84	C32-84	-
Swivel in double extrusion nuts				
M6		A32-67*	C32-67	B32-67
M6		A32-36*	C32-36	-
M4		-	-	B32-47

* for base 50+45

Hammer nuts

Base 50/45/40

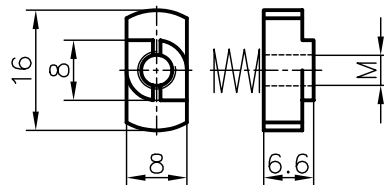

Base 30/20

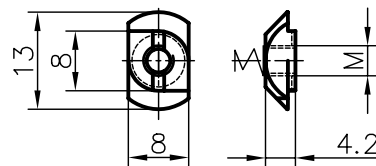

Application

The hammer nut can be subsequently inserted into the profile slot. The nuts can be spaced close together because they are only 8 mm wide. However, their load-bearing capability is clearly lower than those of threaded plates and extrusion nuts.

Specification

Zinc-coated steel; retaining springs: spring steel



Order data

Order number

Thread M		Extrusion base	
		50/45/40	30/20
M3		AC31-35	BD31-35
M4		AC31-45	BD31-45
M5		AC31-55	BD31-55
M6		AC31-65	BD31-65

Magnet nuts

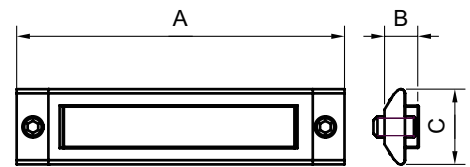

Measurement data

Extrusion base	A	B	C
50	58	11.5	15
40	58	8	15
30	62	6.3	14.2

Application

The magnetnuts can be inserted into the extrusions of the base 50 and 40 on the open cross section. They can be fixed on position with 2 small screws. With the magnet-nuts you can do a flat door fixing, fixing of metal housing or use it for holding tools.

Specification

Surround: plastic
 Screws: zinc-plated
 Magnet: zinc-plated
 Operating temperature: up to 80 °C

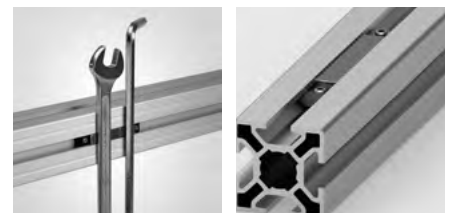

Order data

Order number

Magnet nuts	
Extrusion base	Order number
50	A32-86
40	C32-86
30	B32-86