

# Base extrusion 45x90 Type E01-3

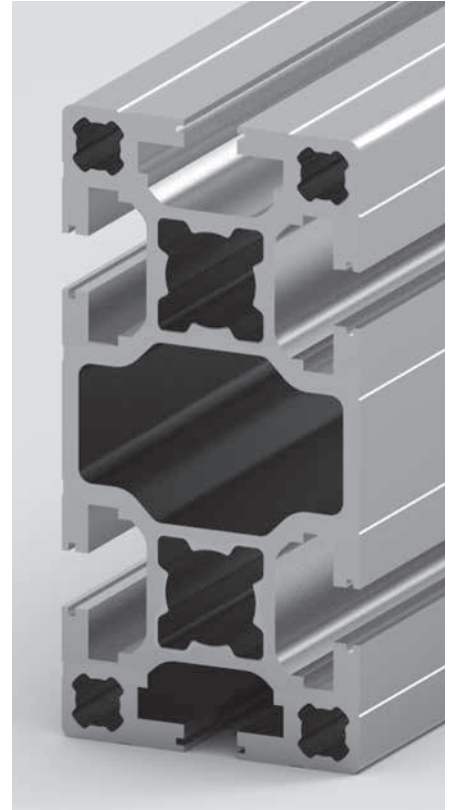
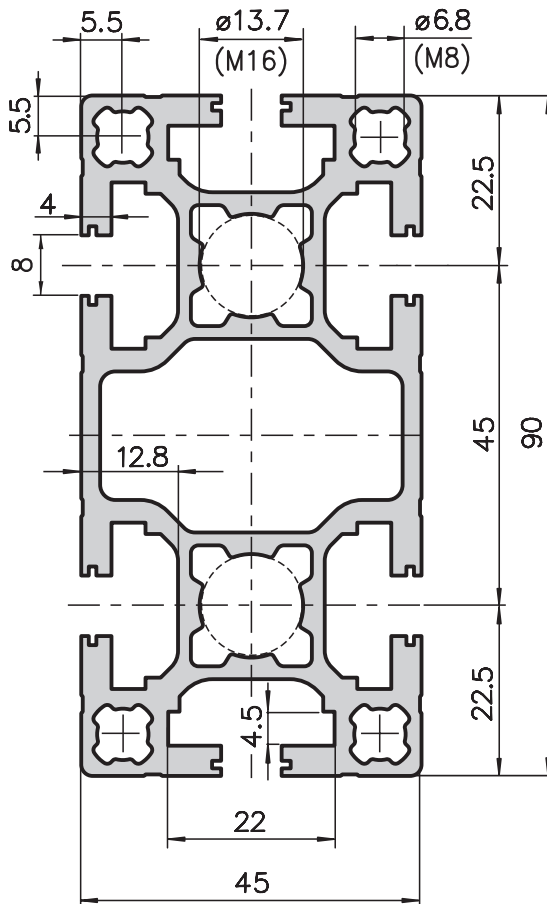

## Application

This base extrusion can also be used for constructions of all types. It is exceptionally stable and its cross section makes a very wide range of applications possible.

## Technical data

$I_x$	=	109.54 cm <sup>4</sup>
$I_y$	=	29.77 cm <sup>4</sup>
$W_x$	=	24.34 cm <sup>3</sup>
$W_y$	=	13.23 cm <sup>3</sup>
Cross-section area	=	12.97 cm <sup>2</sup>
Weight	=	3.50 kg/m

## Order data

## Order number

Base extrusion 45x90	
Standard length 5000 mm	E01-3-00/5000
Base extrusion 45x90	
Cut to length	E01-3-02-02/...
Extra machining	Pages 57-61