

## Corner extrusion 100x100 Type A03-7

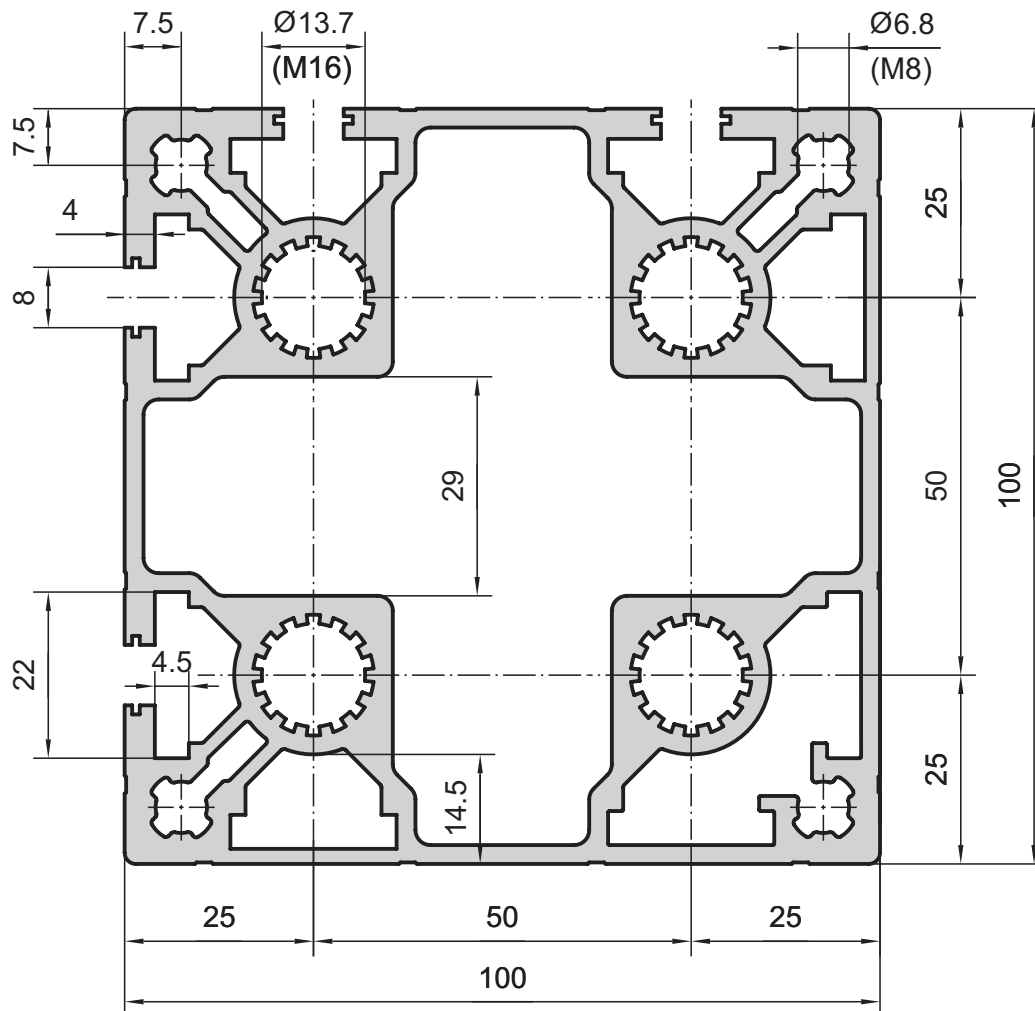

### Technical data

$I_{x, y}$	=	314.10 cm <sup>4</sup>
$W_{x, y}$	=	62.82 cm <sup>3</sup>
Cross-section area	=	26.30 cm <sup>2</sup>
Weight	=	7.10 kg/m

### Order data

### Order number

Corner extrusion 100x100	
Standard length 5000 mm	A03-7-00/5000
Corner extrusion 100x100	
Cut to length	A03-7-02-02/...

Extra machining	Pages 57-61
-----------------	-------------

### Application

Corner extrusions are always used when closed surfaces are required. Particularly with larger machine casings, this extrusion is frequently used as a corner pillar that can absorb weight at the same time, but also optimises the look of the machine. With a base plate (A47-80) a central adjustable foot can also be installed.

